

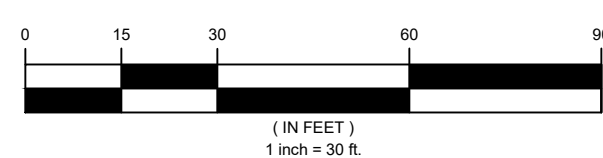

**GRAPHIC SCALE**



**PRELIMINARY NJDEP FLOOD HAZARD AREA NOTES**

1. THE ENTIRE SUBJECT PROPERTY IS LOCATED WITHIN A REGULATED FLOOD HAZARD AREA AS PER REVIEW OF AVAILABLE MAPPING. THE IMPROVEMENTS SHOWN ON THIS PLAN ARE SUBJECT TO NJDEP REVIEW FOR WORK IN THE FLOOD HAZARD AREA.
2. METHOD 3 HAS BEEN UTILIZED TO ESTIMATE THE FLOOD HAZARD AREA DESIGN FLOOD ELEVATION FOR THE PROJECT SITE. THE FLOOD HAZARD DESIGN FLOOD ELEVATION IS ELEVATION 13.20 (FEMA 100 YR ELEVATION: 10.20' + 3' (PER METHOD 3) = 13.20')
3. FEMA 100 YEAR FLOOD ELEVATION PER FEMA FLOOD INSURANCE STUDY VOLUME 5 OF 6, BERGEN COUNTY, NEW JERSEY
4. NO BASEMENTS ARE PERMITTED WITHIN THE FLOOD HAZARD AREA.
5. THE PROPOSED IMPROVEMENTS SHALL BE DESIGNED TO MEET ALL APPLICABLE NJDEP FLOOD HAZARD AREA REGULATIONS AND ALL NJDEP STORMWATER MANAGEMENT REGULATIONS.

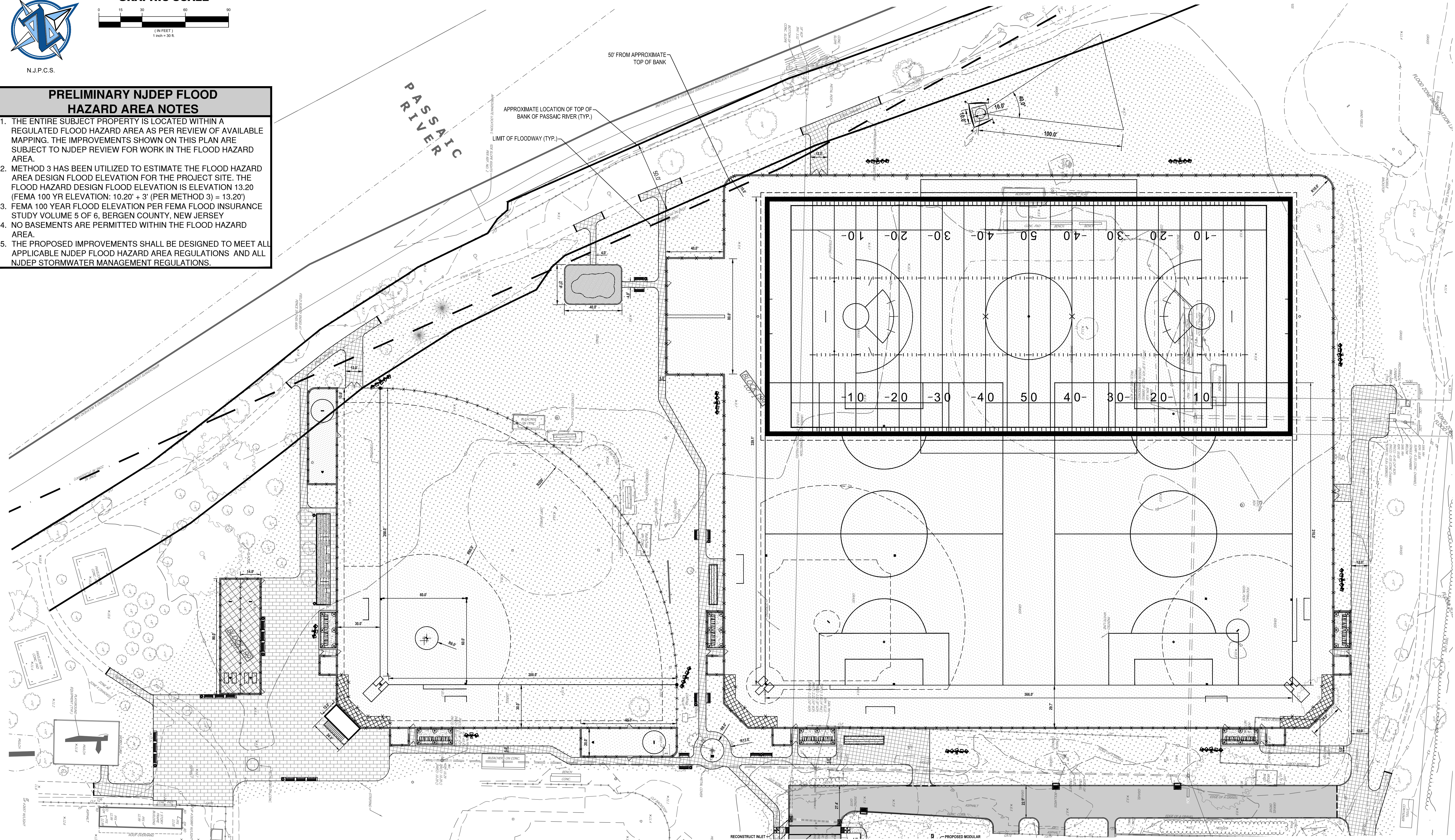

CAUTION: IF THIS DOCUMENT DOES NOT CONTAIN THE RAISED IMPRESSION SEAL OF THE PROFESSIONAL, IT IS NOT AN AUTHORIZED ORIGINAL DOCUMENT AND MAY HAVE BEEN ALTERED. © COPYRIGHT 2024 BY NEGLIA ENGINEERING. ALL RIGHTS RESERVED.

CERTIFICATE OF AUTHORIZATION (N.J.S.A. 45:8-56) 24GA27927000

REVISIONS			DRAWN	DESIGNED	CHECKED
NO.	DATE	DESCRIPTION			

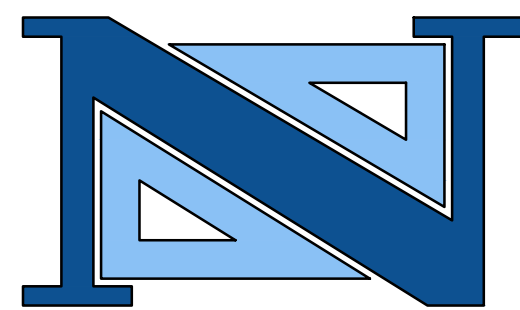

**BRIAN A. INTINDOLA, P.E., P.P.**  
 PROFESSIONAL ENGINEER  
 N.J. LICENSE NO. 41947

**PROFESSIONAL PLANNER**  
 N.J. LICENSE NO. 6475

A PROJECT OF  
**NEGLIA ENGINEERING ASSOCIATES**  
 34 PARK AVENUE  
 TEL: 201-939-8805  
 LYNHURST, NEW JERSEY  
 FAX: 201-939-0846  
 E-MAIL: NEA@NEGLIAENGINEERING.COM

**MICHAEL J. NEGLIA, P.E., P.L.S., P.P.**  
 PROFESSIONAL ENGINEER  
 N.J. LICENSE NO. 38604

**PROFESSIONAL LAND SURVEYOR**  
 N.J. LICENSE NO. 38604

**PROFESSIONAL PLANNER**  
 N.J. LICENSE NO. 33100569800

**PRELIMINARY NJDEP PERMITTING PLAN**  
**DIAMONDS 3 & 4 MULTI-USE FIELD IMPROVEMENTS**  
**BLOCK 199 - LOT 1**  
**BOROUGH OF RUTHERFORD**  
**BERGEN COUNTY**  
**NEW JERSEY**

DRAWN BY: A.A.M.	CHECKED BY: B.A.L.	PROJECT NO:	SHEET NO:
DESIGNED BY: A.A.M.	SCALE: 1" = 30'	RUTHMUN24.014	10 OF 1
FIELD BOOK NO:	PAGE:		DATE: OCTOBER 8, 2024

m:\ruthm\24\1014\1014.dwg (planned) - 10/08/24 10:07:54 AM